

The Universal Clamp is engineered for hanging all types of pipework and ductwork within mechanical and plumbing services.

FEATURES / BENEFITS

- Up to ten times faster than traditional methods
- For pipe sizes 15 mm Copper (OD15) to 4" (OD114) pipework
- Replaces more than 12 different pipe ring sizes
- Simplifies 'take-off' process
- Easy site storage, reduces waste
- Retractable sleeve, pre-fitted to wire rope to prevent galvanic corrosion
- M8/M10 dual thread for versatility during install
- Available with Kooltherm / Armaflex pipe collars for insulated pipe
- Supplied in kits with Gripple Universal Brackets
- Provides insulation against vibration (Noise reduction > 16 db)



INSTALLATION

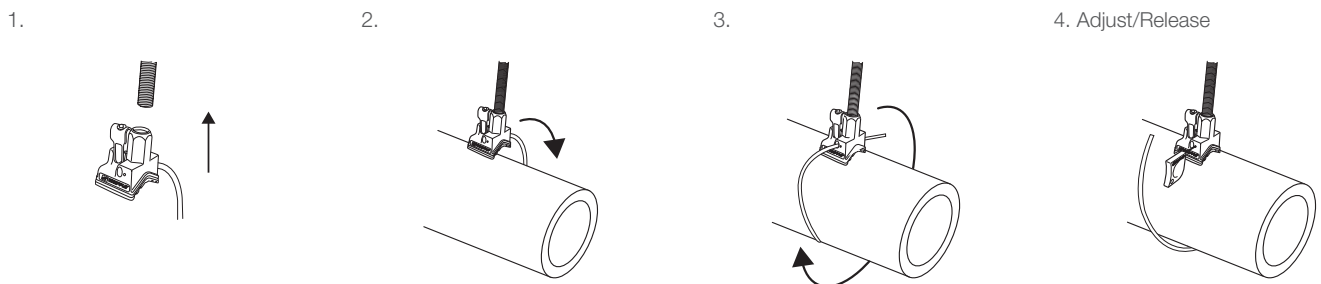

SPECIFICATION

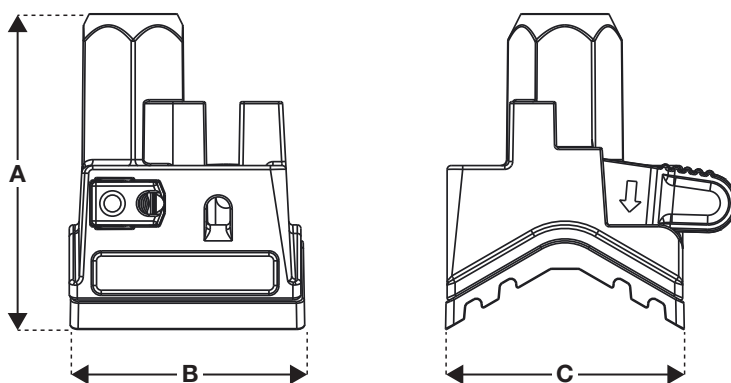

Dimension	Size (mm)
A	40
B	29
C	29.5

AVAILABLE ACCESSORIES



For more options on available accessories please contact us or visit www.gripple.com

SUBMITTAL INFORMATION

Load Rating:

75 kg @ 3:1 safety factor

Material:

Housing - Type ZA2 Zinc

Wedge - Sintered steel hardened to min. 56 Rockwell C

Spring - Stainless Steel (Type 302)

Pad - EPDM 4015 Shore A

Approvals:

Lloyds certified