

Express Range

Tool free locking device for fast suspension of a variety of services, designed with a keyless release mechanism.

- The XP1 is ideal for signage, shopfitting, lighting and other lightweight fixtures
- The XP2 is ideal for mechanical and electrical applications
- Up to six times faster to install than traditional methods
- Keyless; no tool required for adjustment
- Ergonomic buttons allow rapid adjustment
- Discreet and aesthetic design
- Supplied as a ready-to-use kit



Installation & Adjustment

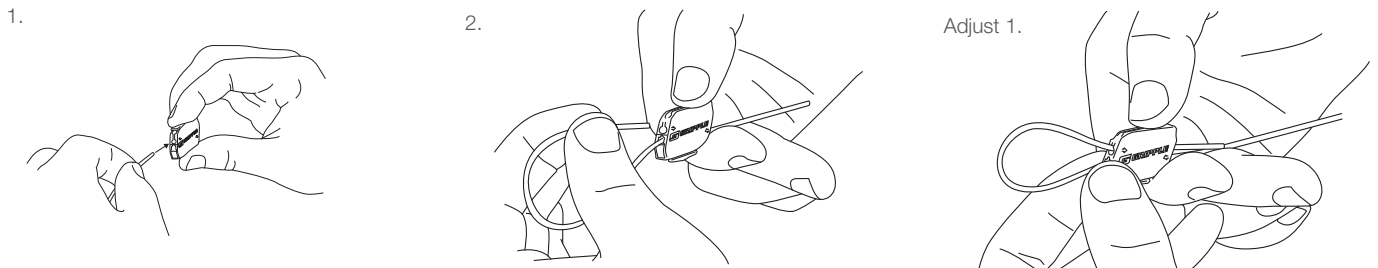

Ensure a minimum 75 mm of tail wire exit the hanger.

Specifications

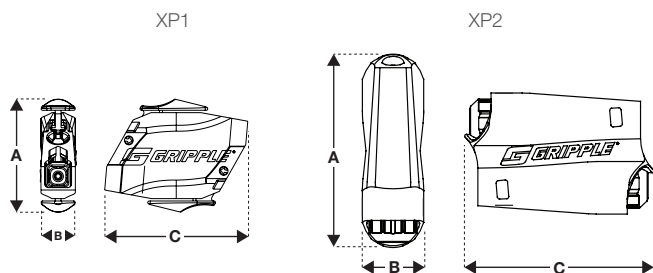

Hanger #	Dimensions			Safe Working Load All with a 5:1 safety factor
	A	B	C	
No. 1	18.5	5.9	23.5	0 - 15 kg
No. 2	21.4	11.6	28.4	0 - 45 kg

Submittal Information

- Housing** - Type ZA2 Zinc
- Wedge** - Sintered steel hardened to min. 56 Rockwell C
- Spring** - Stainless Steel (Type 302)
- End Cap** - Polypropylene (MOPLen EP448T)
- No. 1 Button** - Acetal
- No. 2 Button** - 30% Glass filled Polypropylene

Standard End Fixings



For more options on available end fixings please contact us or visit gripple.net.au